

Mini Cylinder

Double Acting, Single Rod; Single Acting, Spring Return / Extend

Series CM2

◆ How to Order

C D M2 B 40 - 150 A

Action

Nil	Double acting, single rod	S	Single acting, spring return
T	Single acting, spring extend		

Cushion

Nil	Rubber bumper
A	Adjustable air cushion at both ends (only available for double acting)

Cylinder stroke

* Refer to "Standard stroke" .

Bore size (mm)

20	25	32	40
-----------	-----------	-----------	-----------

Mounting style

B	Basic style	T	Head side trunnion style
L	Axial foot style	E	Clevis integrated style
F	Rod side flange style	BZ	Boss-cut basic style
G	Head side flange style	FZ	Boss-cut rod side flange style
C	Single clevis style		
D	Double clevis style	UZ	Boss-cut rod side trunnion style
U	Rod side trunnion style		

Magnet

Nil	Without magnet	D	Built-in magnet
------------	----------------	----------	-----------------



Symbol

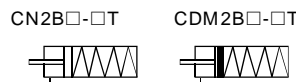
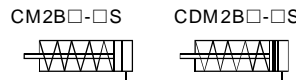
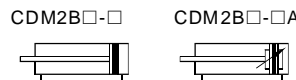
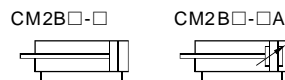

◆ Standard Stroke

Bore size(mm)	Double acting, single rod		Single acting, spring return / extend
	Standard stroke (mm)	Maximum stroke(mm)	Standard stroke (mm)
20	25, 50, 75, 100, 125, 150, 200, 250, 300	1000	25, 50, 75, 100, 125, 150
25		1500	25, 50, 75, 100, 125, 150
32		2000	25, 50, 75, 100, 125, 150, 200
40		2000	25, 50, 75, 100, 125, 150, 200, 250

Mini Cylinder

Double Acting, Single Rod; Single Acting, Spring Return / Extend

Series CM2



◆ Specifications

Bore size (mm)		20	25	32	40
Action	C(D)M2B□-□	Double acting, single rod			
	C(D)M2B□-□-S/T	Single acting, spring return / extend			
Fluid		Filtered compressed air			
Proof pressure		1.5 MPa			
Operating pressure range	C(D)M2B□-□	0.05~1.0 MPa			
	C(D)M2B□-□-S	0.18~1.0 MPa			
	C(D)M2B□-□-T	0.23~1.0 MPa			
Ambient and fluid temperature		-10~70°C (No freezing)			
Port size		Rc1/8			Rc1/4
Piston rod thread		M8×1.25	M10×1.25		M14×1.5
Cushion	C(D)M2B□-□	Rubber bumper			
	C(D)M2B□-□-S/T	Adjustable air cushion at both ends			
		Rubber bumper			

Note): Please contact with ANSSION for the mounting accessories.

◆ Dimensions

C(D)M2B□-□ (Basic style)

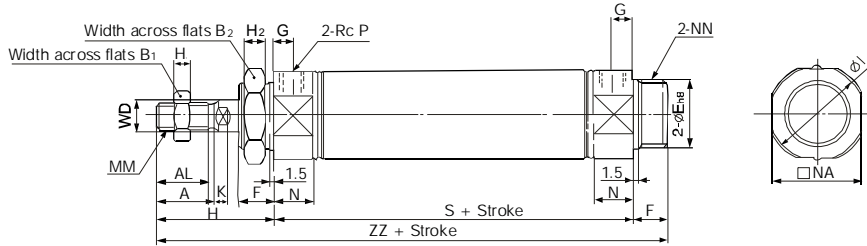

Note): The dimensions of built-in magnet type cylinder are exactly the same as without-magnet type cylinder.

With air cushion

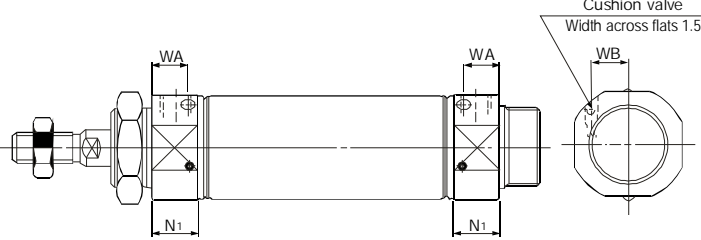

Boss-cut style

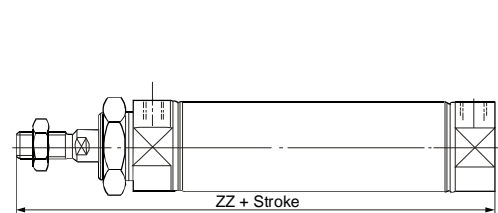

Bore size(mm)	A	AL	B ₁	B ₂	D	E	F	G	H	H ₁	H ₂	I	K	MM	N	NA	NN	P	S	ZZ
20	18	15.5	13	26	8	20 ⁰ _{-0.033}	13	8	41	5	8	28	5	M8×1.25	15	24	M20×1.5	Rc1/8	62	116
25	22	19.5	17	32	10	26 ⁰ _{-0.033}	13	8	45	6	8	33.5	5.5	M10×1.25	15	30	M26×1.5	Rc1/8	62	120
32	22	19.5	17	32	12	26 ⁰ _{-0.033}	13	8	45	6	8	37.5	5.5	M10×1.25	15	34.5	M26×1.5	Rc1/8	64	122
40	24	21	22	41	14	32 ⁰ _{-0.039}	16	11	50	8	10	46.5	7	M14×1.5	21.5	42.5	M32×2.0	Rc1/4	88	154

With Air Cushion

Bore size(mm)	N ₁	WA	WB
20	17.5	13	8.5
25	17.5	13	10.5
32	17.5	13	11.5
40	21.5	16	15

Boss-cut Style

Bore size(mm)	ZZ
20	103
25	107
32	109
40	138

I

CJP

CJ1

DNC

DNCB

DNG

C95

SI

CS1

MB

SU

SC

DSNU

C85

CJ2

CM2

MA

MAL

ADVU

CQ2

CQS

SDA

CU

DPZ

CXS

TN

ADVUL

CQM

MGP

MGG

CRA1

CY1B

CS

Auto switch

D

Auto switch

AC,AD

HR

RB

RBQ

Mini Cylinder

Double Acting, Single Rod; Single Acting, Spring Return / Extend

Series CM2

◆ Dimensions

CM2B□-□S (Spring return style)

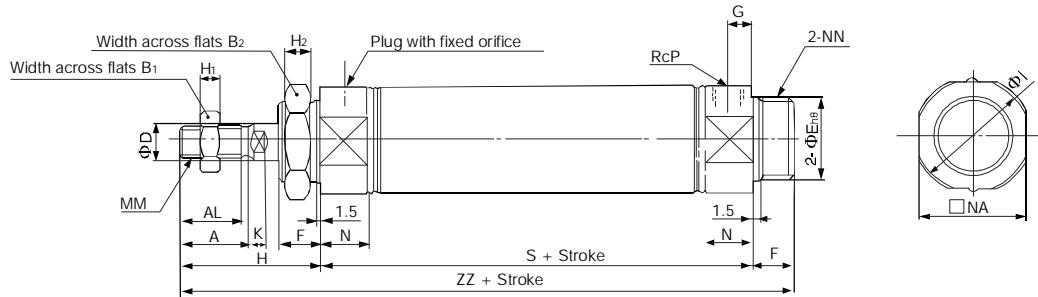

CM2B□-□T (Spring extend style)

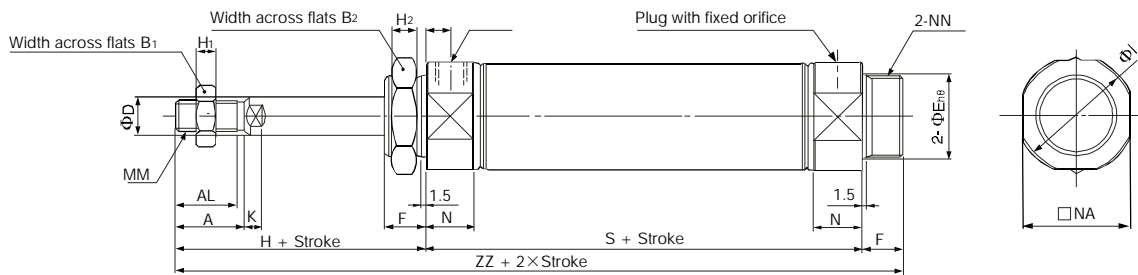

Boss-cut style

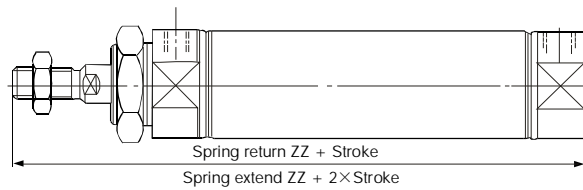

Bore size(mm)	A	AL	B ₁	B ₂	D	E	F	G	H	H ₁	H ₂	I	K	MM	N	NA	NN	P
20	18	15.5	13	26	8	20 ⁰ _{-0.033}	13	8	41	5	8	28	5	M8×1.25	15	24	M20×1.5	Rc1/8
25	22	19.5	17	32	10	26 ⁰ _{-0.033}	13	8	45	6	8	33.5	5.5	M10×1.25	15	30	M26×1.5	Rc1/8
32	22	19.5	17	32	12	26 ⁰ _{-0.033}	13	8	45	6	8	37.5	5.5	M10×1.25	15	34.5	M26×1.5	Rc1/8
40	24	21	22	41	14	32 ⁰ _{-0.039}	16	11	50	8	10	46.5	7	M14×1.5	21.5	42.5	M32×2.0	Rc1/4

Dimensions by Stroke

Bore size (mm)	1 to 50		51 to 100		101 to 150		151 to 200		201 to 250	
	S	ZZ	S	ZZ	S	ZZ	S	ZZ	S	ZZ
20	87	141	112	166	137	191	-	-	-	-
25	87	145	112	170	137	195	-	-	-	-
32	89	147	114	172	139	197	164	222	-	-
40	113	179	138	204	163	229	188	254	213	279

Boss-cut Style

Bore size (mm)	1 to 50		51 to 100		101 to 150		151 to 200		201 to 250	
	ZZ	ZZ	ZZ	ZZ	ZZ	ZZ	ZZ	ZZ	ZZ	
20	128	153	178	-	-	-	-	-	-	
25	132	157	182	-	-	-	-	-	-	
32	134	159	184	209	-	-	-	-	-	
40	163	188	213	238	263	-	-	-	-	