

Mini Cylinder

Double Acting, Single Rod; Single Acting, Spring Return / Extend

Series MA, MAC, MSA, MTA



◆ How to Order

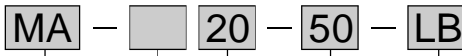

Mounting style

Nil	LB	FA	SDB

* (1) Φ50, Φ63 are all with air cushion.
 (2) CM type is only available for Φ50, Φ63.

Cylinder stroke

* Refer to "Standard stroke" .

Bore size

Back cover type

Nil	Pivot type	U	Flat-end type	CM	Round-end type
-----	------------	---	---------------	----	----------------

* CM only for MAC Series.

Model*

MA	Double acting	MAC	Double acting with air cushion
MSA	Single acting, Spring return	MTA	Single acting, Spring extend

* MA,MAC,MSA,MTA all is built-in magnet .



MA Series



MAC Series

Symbol

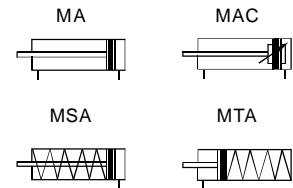

◆ Specifications

Bore size (mm)		16	20	25	32	40	50	63	
Action	MA / MAC	Double acting type							
	MSA / MTA	Single acting type							
Fluid		Filtered compressed air							
Proof pressure		1.35 MPa							
Operating pressure range	MA / MAC	0.1~0.9 MPa							
	MSA / MTA	0.2~0.9 Mpa							
Ambient and fluid temperature		-5~70℃ (No freezing)							
Port size		M5×0.8	Rc1/8				Rc1/4		
Piston rod thread		M6×1.0	M8×1.25	M10×1.25		M12×1.25	M14×1.5		
Cushion	MA / MSA / MTA	Rubber bumper						Adjustable air cushion at both ends	
	MAC	Adjustable air cushion at both ends							

Note): Please contact with ANSSION for the mounting accessories.

Basic

◆ Standard Stroke

Series	Bore size (mm)	Standard stroke(mm)												Maximum stroke	Available stroke				
MA MAC	16	25	50	75	80	100	125	150	160	175	200	300	500						
	20	25	50	75	80	100	125	150	160	175	200	250	300	500	650				
	25~63	25	50	75	80	100	125	150	160	175	200	250	300	350	400	450	500	500	650
MSA	16	25	50	75													100	100	
MTA	20~40	25	50	75	100													100	100

I

CJP

CJ1

DNC

DNCB

DNG

C95

SI

CS1

MB

SU

SC

DSNU

C85

CJ2

CM2

MA

MAL

ADVU

CQ2

CQS

SDA

CU

DPZ

CXS

TN

ADVUL

CQM

MGP

MGG

CRA1

CY1B

CS

Auto switch

D

Auto switch

AC,AD

HR

RB

RBQ

Mini Cylinder

Double Acting, Single Rod; Single Acting, Spring Return / Extend

Series MA, MAC, MSA, MTA

◆ Dimensions

MA□-□ φ 16 to 40

MAC□-□

(Pivot style)

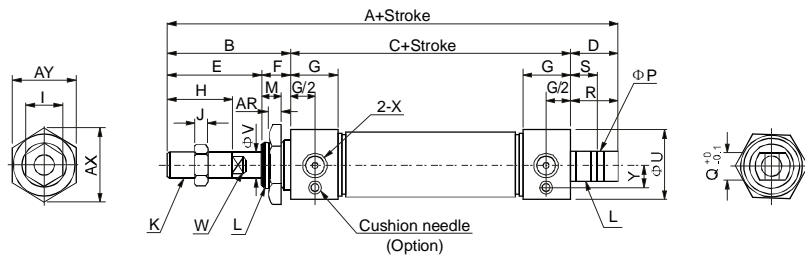

MA-U□-□ φ 16 to 40

MAC-U□-□

(Flat-end style)

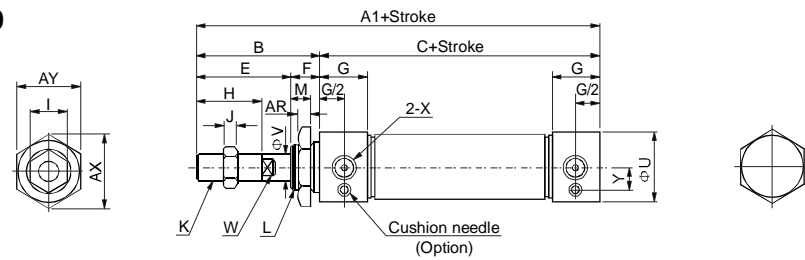

Bore size(mm)	A	A1	B	C	D	E	F	G	H	I	J	K
16*	114	98	38	60	16	22	16	10	16	10	5	M6×1.0
20	137	116	40	76	21	28	12	16	20	12	6	M8×1.25
25	141	120	44	76	21	30	14	16	22	17	6	M10×1.25
32	147	120	44	76	27	30	14	16	22	17	6	M10×1.25
40	149	122	46	76	27	32	14	16.7	24	17	7	M12×1.25

Bore size(mm)	L	M	P	Q	R	S	U	V	W	X	AR	AX	AY	Y#
16*	M16×1.5	14	6	12	14	9	21	6	5	M5	6	25	22	-
20	M22×1.5	10	8	16	19	12	27	8	6	Rc1/8	7	33	29	9
25	M22×1.5	12	8	16	19	12	30	10	8	Rc1/8	7	33	29	10.5
32	M24×2.0	12	10	16	25	15	35	12	10	Rc1/8	8	37	32	13
40	M30×2.0	12	12	20	25	15	41.6	16	14	Rc1/8	9	47	41	15

* MAC type starts from 20mm bore size, #MA type is without this dimension.

MA□-□ φ 50 to 63

MAC□-□

(Pivot style)

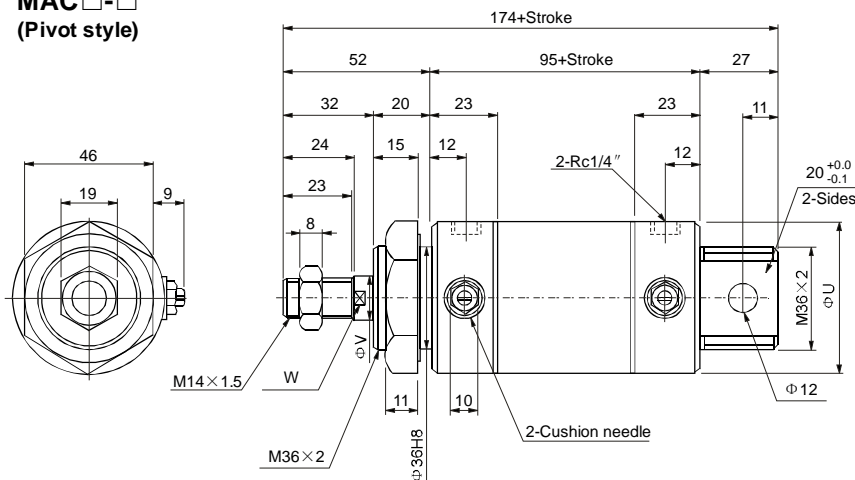

Bore size(mm)	U	V
50	53	16
63	67	16

Flat-end style

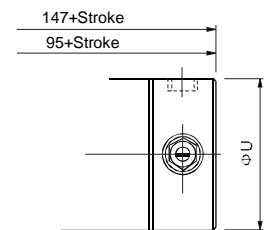

Round-end style

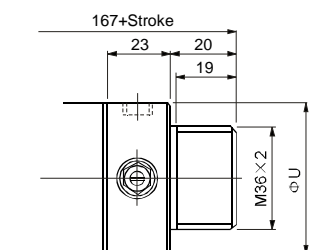

Mini Cylinder

Double Acting, Single Rod; Single Acting, Spring Return / Extend

Series MA, MAC, MSA, MTA



MSA□-□ φ 16 to 40
(Pivot style)

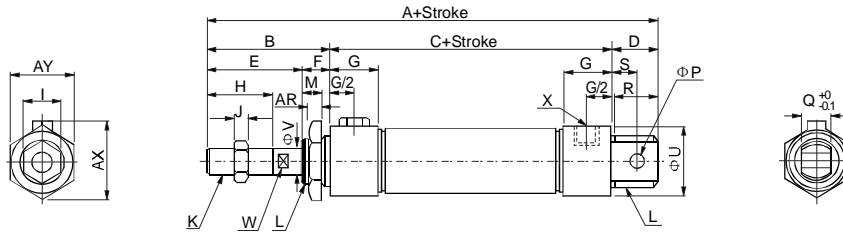

MSA-U□-□ φ 16 to 40
(Flat-end style)

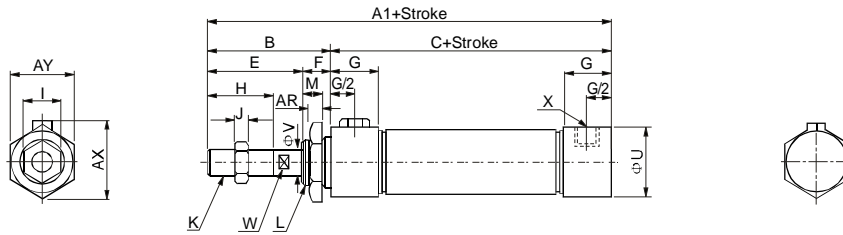

MTA□-□ φ 16 to 40
(Pivot style)

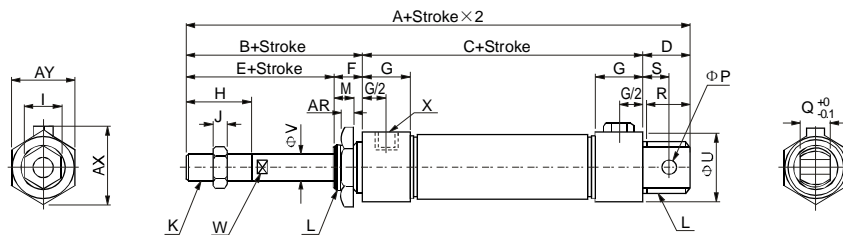

MTA-U□-□ φ 16 to 40
(Flat-end style)

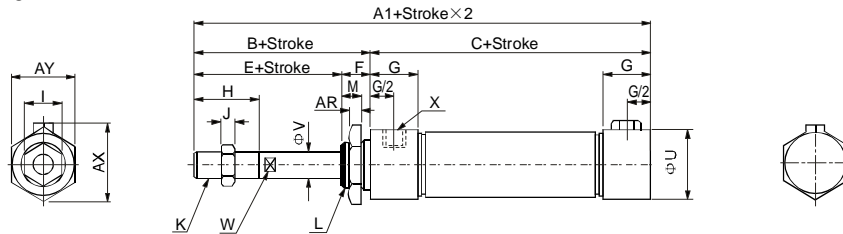

Bore size(mm)	A		A1		B	C		D	E	F	G	H	I	J	K
	0-50	51-100	0-50	51-100		0-50	51-100								
16	114	139	98	123	38	60	85	16	22	16	10	16	10	5	M6×1.0
20	137	162	116	141	40	76	101	21	28	12	16	20	12	6	M8×1.25
25	141	166	120	145	44	76	101	21	30	14	16	22	17	6	M10×1.25
32	147	172	120	145	44	76	101	27	30	14	16	22	17	6	M10×1.25
40	149	174	122	147	46	76	101	27	32	14	16.7	24	17	7	M12×1.25

Bore size(mm)	L	M	P	Q	R	S	U	V	W	X	AR	AX	AY
16	M16×1.5	14	6	12	14	9	21	6	5	M5×0.8	6	25	22
20	M22×1.5	10	8	16	19	12	27	8	6	Rc1/8	7	33	29
25	M22×1.5	12	8	16	19	12	30	10	8	Rc1/8	7	33	29
32	M24×2.0	12	10	16	25	15	35	12	10	Rc1/8	8	37	32
40	M30×2.0	12	12	20	25	15	41.6	16	14	Rc1/8	9	47	41

- I
- CJP
- CJ1
- DNC
- DNCB
- DNG
- C95
- SI
- CS1
- MB
- SU
- SC
- DSNU
- C85
- CJ2
- CM2
- MA**
- MAL
- ADVU
- CQ2
- CQS
- SDA
- CU
- DPZ
- CXS
- TN
- ADVUL
- CQM
- MGP
- MGG
- CRA1
- CY1B
- CS
Auto switch
- D
Auto switch
- AC,AD
- HR
- RB
- RBQ